

# ANNEX 1 – Road Closure Map

www.invarion.com

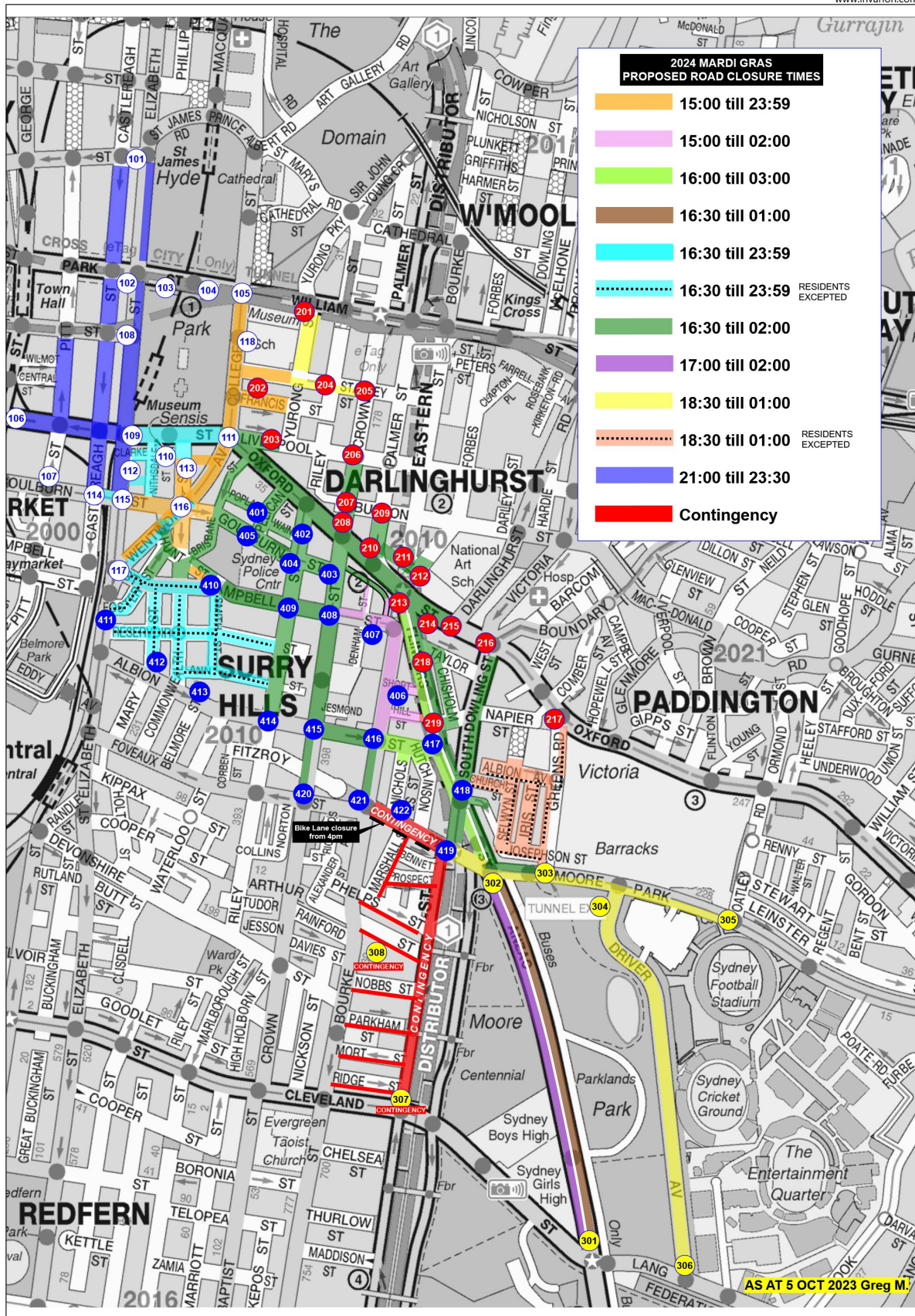

# ANNEX 6 (a) - START AREA MAP

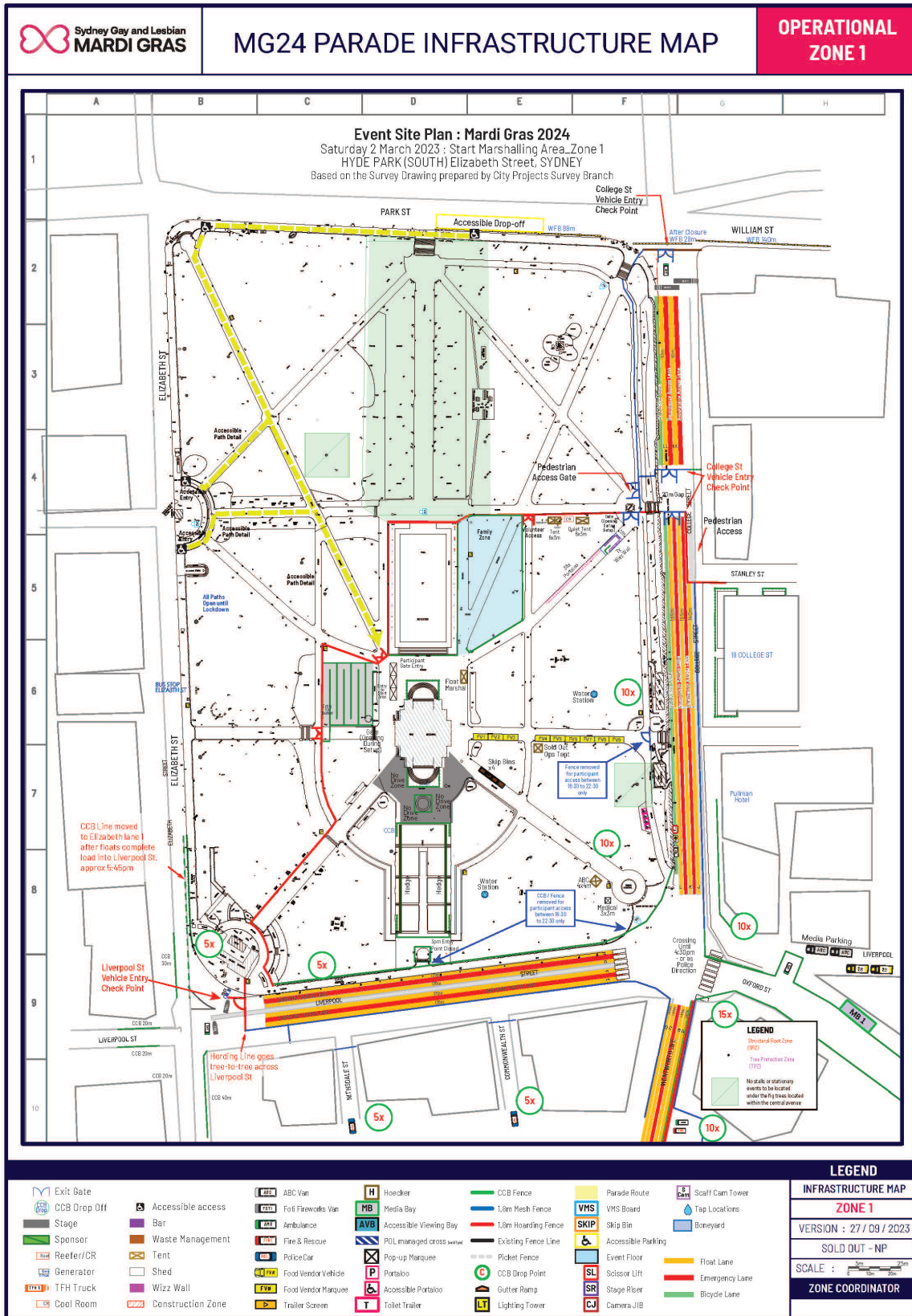

# ANNEX 7 - PARADE ROUTE MAP

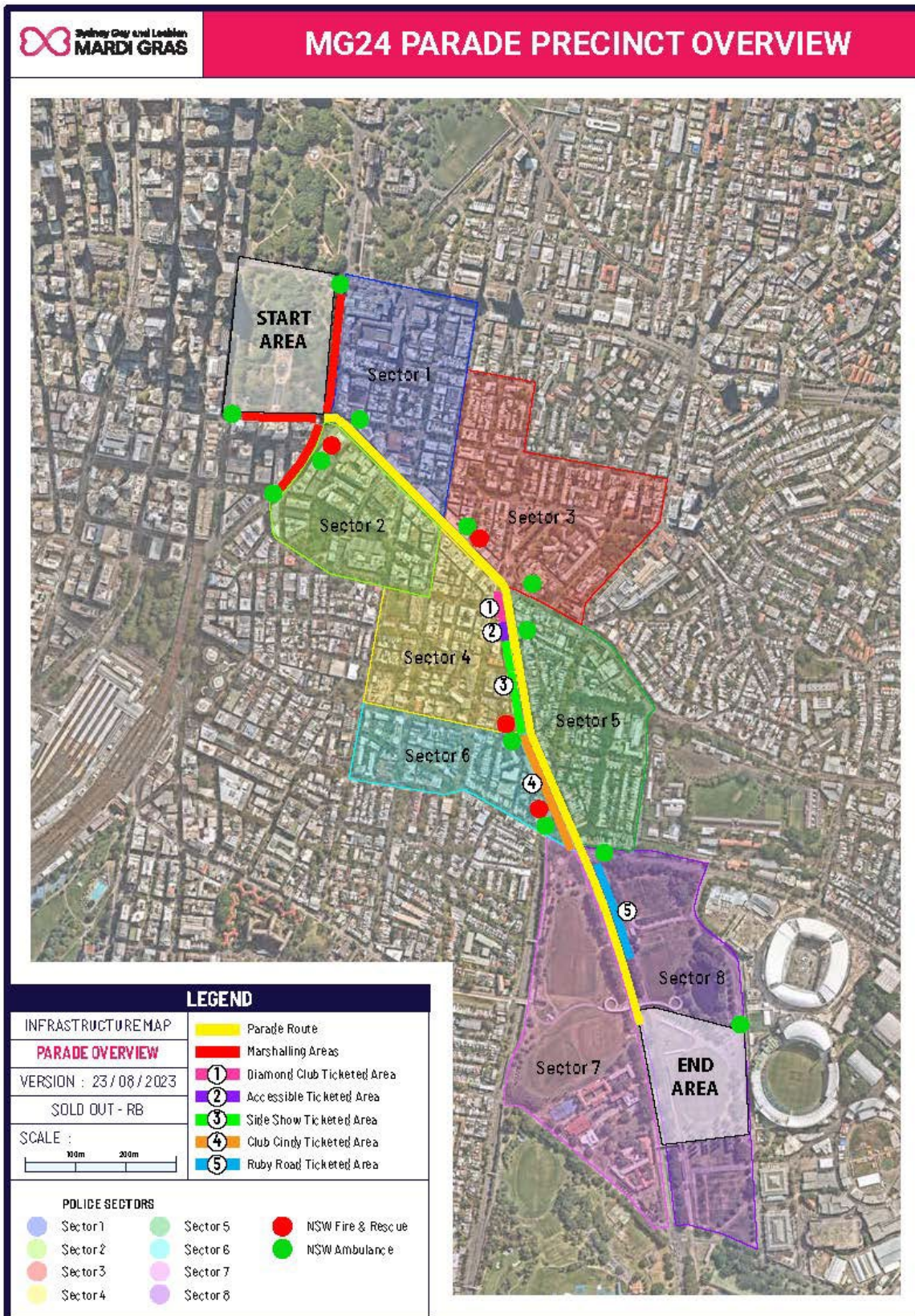



# ANNEX 17 - ON ROAD INFRASTRUCTURE

Flinders Street north bound between Moore Park Rd and Linden Lane SURRY HILLS

Phase 1 (2 lanes): 2300 (Friday) till 0600 (Refer to TGS 701a, 702a & 703a)

Phase 2 (1 lanes): 0600 till 1300 (Refer to TGS 701b, 702b & 703b)

Phase 3 (2 lanes): 1300 till 1600 (Refer to TGS 701c, 702c & 703c)

Flinders Street Full Road Closures: from 1600

